

Front Side Mount

John Deere

8560,8760,8960

8570,8770,8870,8970

9100,9200,9300,9400

9120,9220,9320,9420,9520,9620

PARTS LIST

ITEM	QTY	PART NUMBER	DESCRIPTION
1	1	10-1020	7 x 7 x 16' Tube
2	2	10-1011	300 Saddle
3	2	10-1013	400 Saddle
4	4	60-1033	3/8 x 4 x 6 Angle x 11 in
5	1	10-1513L	60-70-9030 Side Plate LH
6	1	10-1513R	60-70-9030 Side Plate RH

Price List

300 gal w/Tanks \$5875.00

400 gal w/Tanks \$6552.00

Limitations may apply. Please consult
API Sales at 800-288-1117.

Bolt List

QTY	Description	Placement
16	3/4 x 2 1/2 Bolts	4 x 6 Angle to Saddle
16	3/4" Lockwashers	
16	3/4" Nuts	
10	7/8" x 3 Bolts	Side Plates to Tractor
10	7/8" Lockwasher	
10	7/8" Nuts	
10	24mm Hardened Flatwashers	use with 7/8" Bolts
4	1" x 7" x 9" U-bolts	Tractor Plates to Tube
4	1" x 7" x 9" U-bolts	Saddle Angle to Tube
16	1" Lockwashers	
16	1" Nuts	
4	5/8 x 3" Bolts	Side Plate to Tractor
4	5/8" Lockwasher	
4	5/8" Nuts	
4	Nylon Straps	Tank to Saddle

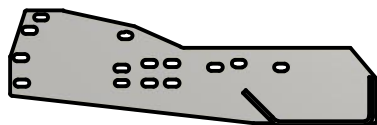

Front

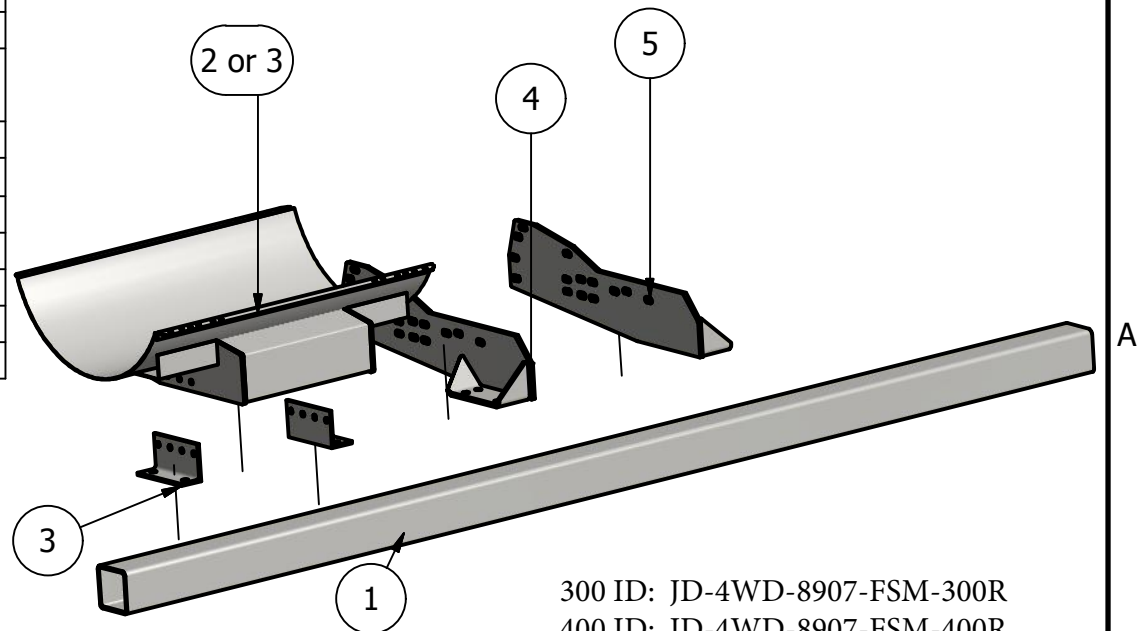

300 ID: JD-4WD-8907-FSM-300R

400 ID: JD-4WD-8907-FSM-400R